

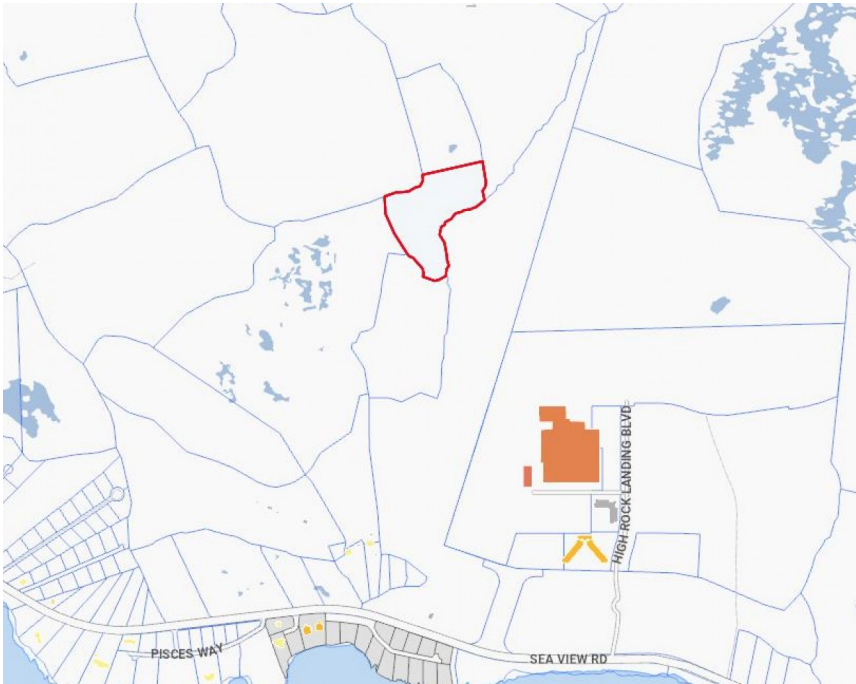

FOR SALE
KYD\$455,419

Current



6. 97 Acres of inland approved Planned Area Development with multi zoning, perfect for a mixed use development with residential, commercial, community and industrial zoning.

Location:

East End

Features:

- Inland**
- High Density Residential**



SCAN ME TO FIND OUT MORE

MLS: 413160

Kim Lund

Broker / Owner
kim.lund@remax.ky

+1 (345) 949 9772

Michael Binckes

Sales Associate
michael.binckes@remax.ky

+1 (345) 945 2011

remax.ky

member of **cireba**



FOR SALE
KYD\$455,419

Current

Property Features

Location **East End**
Type **High Density Residential**

MLS # **413160**

View **Inland**

Additional Information

Title **Freehold**

Water Frontage **No**

Running Costs

Sewage in Maintenance Costs **No**

AC in Maintenance Costs **No**

Gardening in Maintenance Costs **No**

TV in Maintenance Costs **No**

Insurance Included in Maintenance **No**

Pest in Maintenance Costs **No**



Kim Lund

Broker / Owner
kim.lund@remax.ky

+1 (345) 949 9772



Michael Binckes

Sales Associate
michael.binckes@remax.ky

+1 (345) 945 2011

remax.ky

member of  **cireba**