



FOR SALE
KYD\$1,475,000

Current







'Q', South Sound located in the prestigious locale of South Sound offers a luxury lifestyle living. 2BR/2.5BA, 2900 sq. ft. townhouses offering modern architecture, two swimming pools, gym and 200 ft. beach.

Location:

 **South Sound**

Features:

-  **2900 Sq Ft.**
-  **2 Bedrooms**
-  **2.5 Bathrooms**
-  **Beach View, Pool View**
-  **Condominium**



SCAN ME TO FIND OUT MORE

MLS: 414411

Heather Richards

Sales Associate
heather.richards@remax.ky

+1 (345) 943 8573

Edna Ebanks

Sales Associate
edna.ebanks@remax.ky

+1 (345) 949 0681

remax.ky

member of  **cireba**



FOR SALE
KYD\$1,475,000

Current



GARAGE

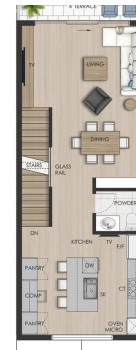

FIRST



SECOND

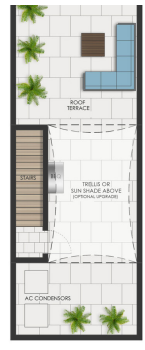

ROOF



Heather Richards

Sales Associate
heather.richards@remax.ky

+1 (345) 943 8573

Edna Ebanks

Sales Associate
edna.ebanks@remax.ky

+1 (345) 949 0681

remax.ky

member of cireba



FOR SALE
KYD\$1,475,000

Current

Property Features

Location	South Sound	MLS #	414411	View	Beach View, Pool View
Beds	2	Bathrooms	2.5	Sq. Ft	2900
Year	2024	Type	Condominium		

Building Features

- | | | |
|---------------|----------------|-----------------|
| ● Cable TV | ● Dishwasher | ● Living room |
| ● City Water | ● Garage: 2 | ● Microwave |
| ● Dining area | ● Kitchen area | ● Multi-Zone AC |

Additional Information

Title	Freehold	Class	Pre-Construction	Total # of Units	22
Construction	Block	Land Certificate	Not Issued	Water Frontage	Yes
Floor Level	1	Stories	3	Foundation	Pier & Beam
Strata #	1				

Running Costs

Monthly Insurance	CI\$1	Sewage in Maintenance Costs	Yes	AC in Maintenance Costs	No
Monthly Maintenance Costs	CI\$1	Gardening in Maintenance Costs	Yes	TV in Maintenance Costs	No
Insurance Included in Maintenance	No	Pest in Maintenance Costs	No		

Heather Richards

Sales Associate
heather.richards@remax.ky

+1 (345) 943 8573

Edna Ebanks

Sales Associate
edna.ebanks@remax.ky

+1 (345) 949 0681

remax.ky

member of  **cireba**