

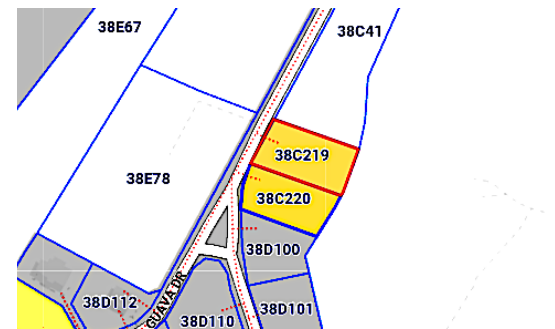

FOR SALE

KYD\$480,000

Current



Excellent location and easy access to Countryside Shopping Center, Bodden Town public beach, and Schools. Both properties are filled and ready for your dream home or your next investment project.

Location:

 **Savannah / Lower Valley**

Features:



Inland



Low Density Residential



SCAN ME TO FIND OUT MORE

MLS: 415017

Lavern Welcome

Sales Associate
lavern.welcome@remax.ky

+1 (345) 233-5228

remax.ky

member of  **cireba**



FOR SALE
KYD\$480,000

Current

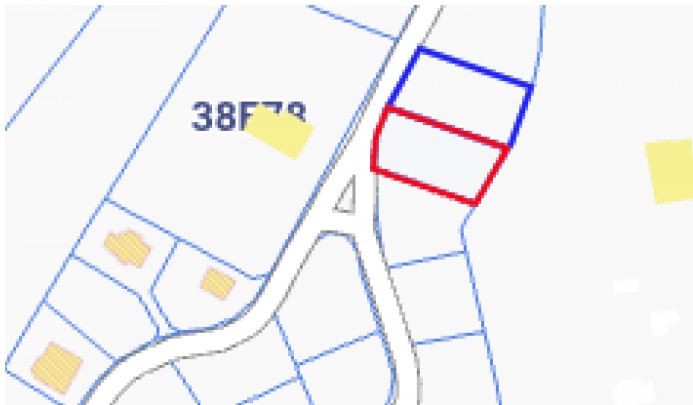

Lavern Welcome

Sales Associate
lavern.welcome@remax.ky

+1 (345) 233-5228

remax.ky

member of  **cireba**



FOR SALE
KYD\$480,000

Current

Property Features

Location **Savannah / Lower Valley**
Type **Low Density Residential**

MLS # **415017**

View **Inland**

Additional Information

Water Frontage

No

Running Costs

Sewage in
Maintenance
Costs **No**

AC in
Maintenance
Costs **No**

Gardening in
Maintenance
Costs **No**

TV in
Maintenance
Costs **No**

Insurance
Included in
Maintenance **No**

Pest in
Maintenance
Costs **No**



Lavern Welcome

Sales Associate
lavern.welcome@remax.ky

+1 (345) 233-5228

remax.ky

member of  **cireba**